

SERIES 8500 STYLE

PTFE lip seals are an alternative that bridges the gap between elastomer lip seals and mechanical carbon face seals, particularly in applications where higher pressure, speeds or other harsh conditions go beyond the capabilities of oil seals.

The typical size range is for shaft diameters from .125" (3 mm) to 10" (254 mm).

APPLICATIONS INCLUDE:

- » General multipurpose rotary applications, opposing sealing lips sealing two medias
- » Suitable for use in fans, pumps, compressors, gear-boxes, mixers

NORMAL OPERATING CONDITIONS

- » Pressures up to 60 psi (≤ 4 bar)
- » Temperatures from -40 °F to 500 °F (-40 °C to 260 °C)
- » Rotary speeds up to 5,000 fpm (≤ 25.4 m/s)

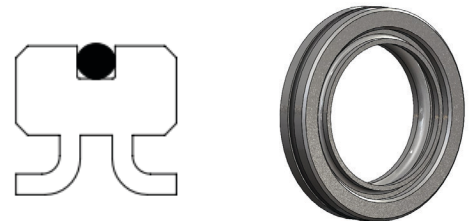

PTFE BODY

- » Body is machined from PTFE and provides the means for the sealing lip
- » Sizes can be customizable based on hardware
- » Provides the space for the O-Ring

SEALING LIP (ELEMENT)

- » Fits firmly against the shaft, sleeve or sealing surface
- » Prevents contamination or leakage
- » PTFE based materials compounded with fillers depending on applications parameters and requirements

O-RING

- » Prevents seal from rotating with the shaft
- » Material options depending on media and temperatures
- » FKM, Silicone, NBR, EPDM, FDA grades

